

BUILDINGS ORDINANCE (Chapter 123)
(Section 35)

SERVICE OF ORDER

In accordance with the proviso to section 35 of the Buildings Ordinance, I append a copy of an order together with the available particulars of the person to whom it is addressed as detailed below:—

**Superseding Order by the Building Authority under section 24(1)
of the Buildings Ordinance (Cap. 123) and under section 46
of the Interpretation and General Clauses Ordinance (Cap. 1)**

Order No. :	UBZ/U01/0673/01	Office of the Building Authority 12/F - 18/F, Pioneer Centre, 750 Nathan Road, Mongkok, Kowloon
BD Ref. :	EB/2212/69/M02b (BUC)	
To :	The owner of Flat B, 2nd Floor, No. 31 Elgin Street, Hong Kong	Date : 13 January 2017

Owner(s) of the premises at: Flat B, 2nd Floor, No. 31 Elgin Street, Hong Kong
on (Lot Number) I.L. 120 s. A ss.5

It has been brought to my attention that the following building works have been carried out in or at the above premises:

- (i) 1 structure attached to the external wall facing the rear lane;
- (ii) 1 structure attached to the external wall facing Nos. 33-35 Elgin Street; and
- (iii) 1 structure attached to the external wall at the re-entrant facing Nos. 33-35 Elgin Street.

(The location of the building works described above is shown hatched-black on the plan annexed hereto, for the purpose of identification only.)

2. For the said building works:

- (a) The building works at items (i), (ii) and (iii) above have been carried out without having first obtained from me the approval of building plans and consent for the commencement of such building works required by section 14 of the Buildings Ordinance.

3. In exercise of the powers vested in me under section 24(1) of the Buildings Ordinance, I hereby order you to :-

- (a) demolish the said building works described under items (i), (ii) and (iii) above; and
- (b) reinstate the parts of the building so affected by the building works under items (i), (ii) and (iii) above in accordance with the plans approved by the Building Authority.

Adequate precautionary measures to ensure public safety should be provided prior to and during the course of works.

4. You are required to commence the works ordered by me in paragraph 3 above within 30 days and complete such works within 60 days of the date of this order, all to the satisfaction of the Building Authority.

5. Section 46 of the Interpretation and General Clauses Ordinance (Cap. 1) provides, inter alia, that where any Ordinance confers power upon any person to make any order, such power shall include power to substitute another order for the one already made. Pursuant to that section, the Building Authority who is empowered under section 24(1) of the Buildings Ordinance (Cap. 123) to make the previous orders i.e. Order No. UBZ/U01/0662/01 dated 7 June 2002 and Order No. C/TA/003140/07/HK dated 18 June 2007 is also empowered to make this order which substitutes the previous orders.

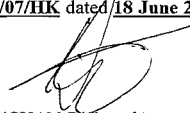

(CHAN Dick-wah)
Principal Survey Officer (Building)
for Building Authority

c.c. SCO/ A&B

Note

- (1) Your attention is drawn to the provisions of sections 24(3), 24(4A) and 33 of the Buildings Ordinance.
- (2) Should you wish to appeal against my Order, you may give notice of appeal to the Secretary to the Appeal Tribunal (Buildings) and the notice should be received by the Secretary not later than 21 days after the date of this Order (Address : 17/F, West Wing, Central Government Offices, 2 Tim Mei Avenue, Tamar, Hong Kong and the fax number is 2189 7334). If you need further information, please refer to the covering letter together with a copy of this Order sent to you by registered mail or visit the Buildings Department's website (www.bd.gov.hk).

BD 109as (Rev. 07/2011)

The original copy of this order was posted upon a conspicuous part of the identified premises on its date of issue.

13 January 2017

LO Cho-ki *Chief Building Surveyor*
for *Building Authority*

Plan annexed to Order No. UBZ/U01/0673/01
 此圖則附連於命令編號 UBZ/U01/0673/01

(FACING REAR LANE)

第(i)項
 在面向後巷的外牆附建 1 個搭建物
 Item (i)
 1 structure attached to the external wall
 facing the rear lane

第(ii)項
 在內角面向伊利近街 33 號至 35 號的外牆
 附建 1 個搭建物
 Item (ii)
 1 structure attached to the external wall at
 the re-entrant facing Nos. 33-35 Elgin Street

第(iii)項
 在面向伊利近街 33 號至 35 號的外牆附建
 1 個搭建物
 Item (ii)
 1 structure attached to the external wall
 facing Nos. 33-35 Elgin Street

(FACING NO. 33-35 ELGIN STREET)

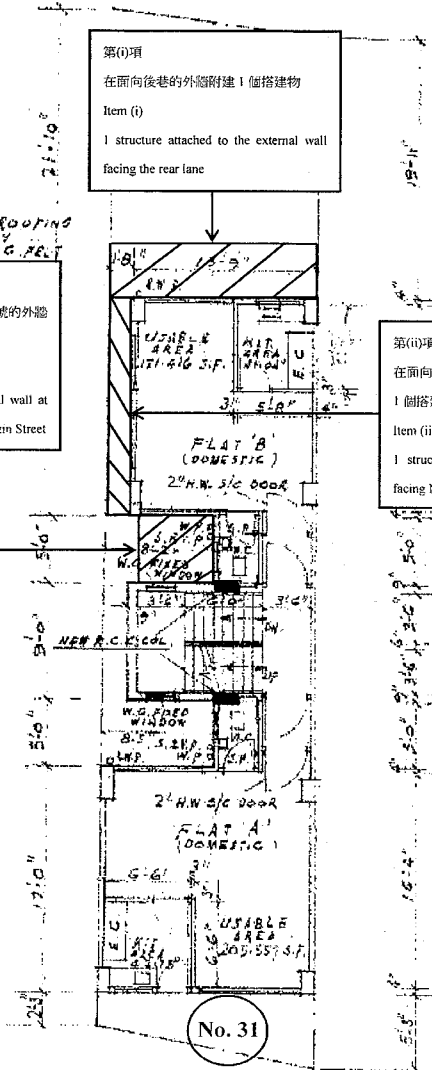

(FACING ELGIN STREET)

2/F Plan